



**12675 Crenshaw Blvd**  
**Hawthorne, CA 90250**



A DIVISION OF  
 **LEE & ASSOCIATES**

**SIZE**

± 21,408 SF  
with ± 1,400 SF of Office Space

**POWER\***

800 Amps/3 Phase/4 Wire/120/240 Volt

\*Tenant to Verify Power

**RENT**

\$1.50/SF, NNN (est. \$0.32/SF)

**LOADING**

2 Dock High Doors with Dock Levelers

**PARKING**

21 Spaces

**FEATURES**

- Fully Insulated Roof
- Fully Air Conditioned Offices and Warehouse
- 24' Clear Height

**OCCUPANCY**

30 Days





# SITE MAP

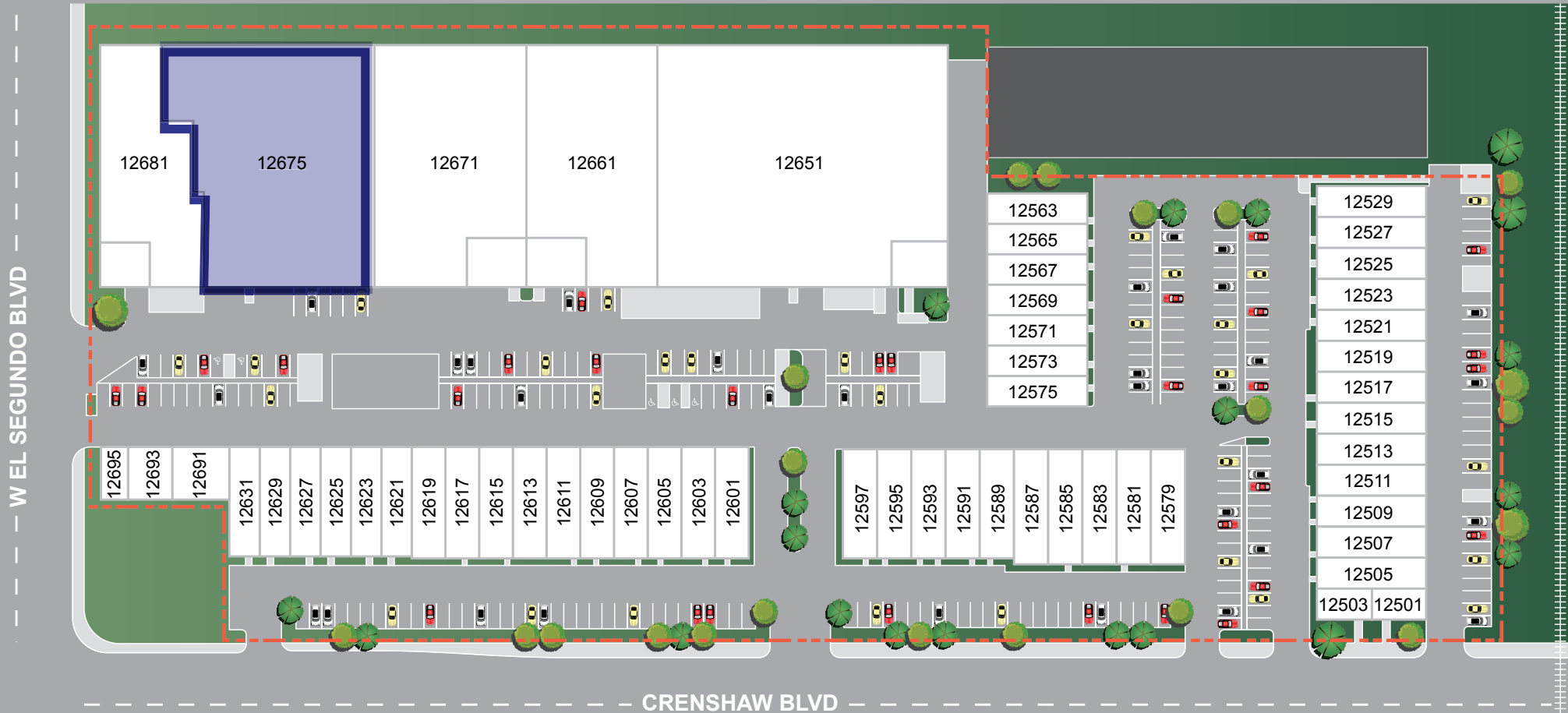

# FLOOR PLAN

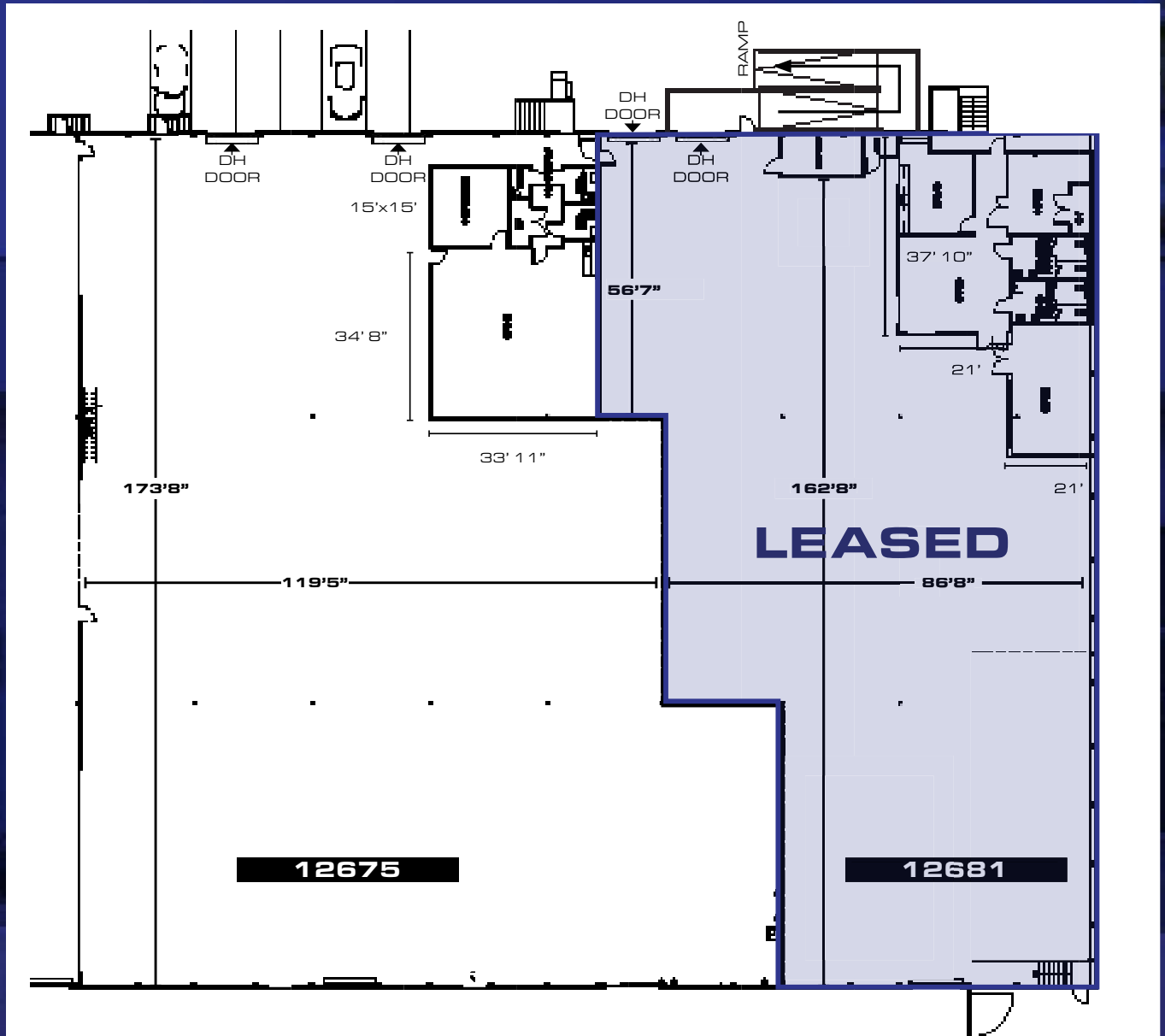

# TRUCK PATH

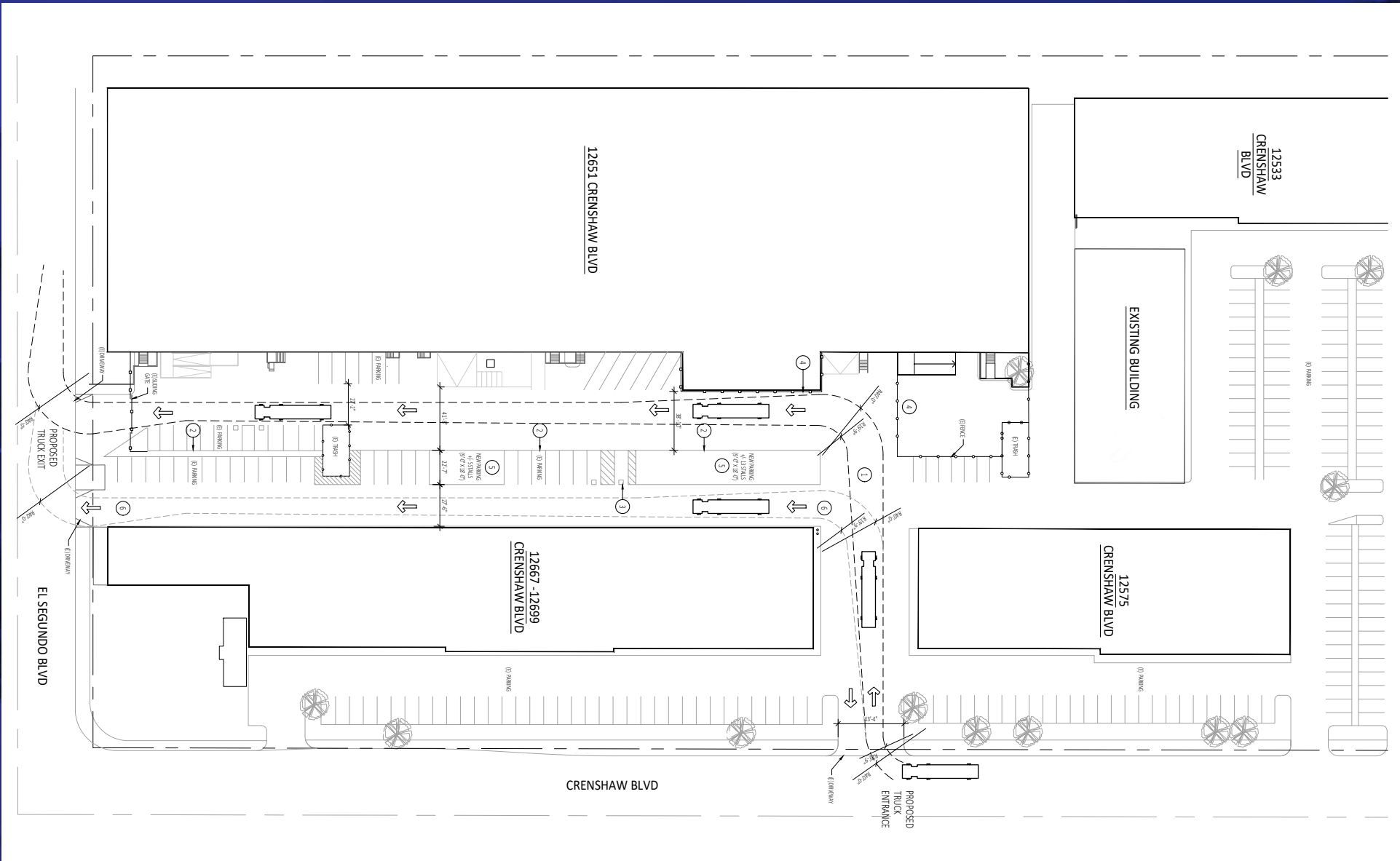

# TENANTS IN THE AREA

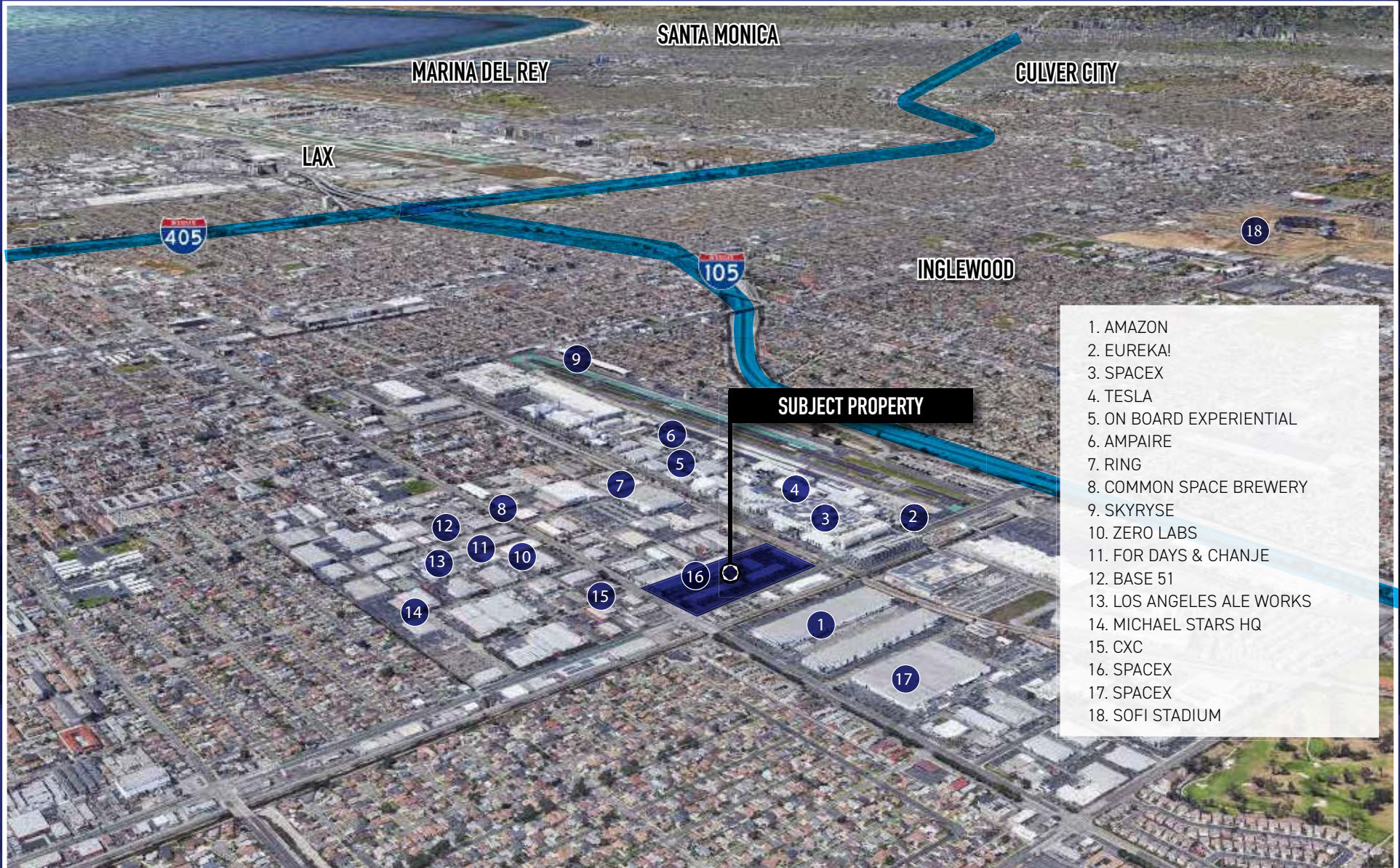

- 1. AMAZON
- 2. EUREKA!
- 3. SPACE X
- 4. TESLA
- 5. ON BOARD EXPERIENTIAL
- 6. AMPAIRE
- 7. RING
- 8. COMMON SPACE BREWERY
- 9. SKYRYSE
- 10. ZERO LABS
- 11. FOR DAYS & CHANJE
- 12. BASE 51
- 13. LOS ANGELES ALE WORKS
- 14. MICHAEL STARS HQ
- 15. CXC
- 16. SPACE X
- 17. SPACE X
- 18. SOFI STADIUM





**Aleks Trifunovic**

President | AGT DRE #01363109  
310.899.2718  
atrifunovic@leewestla.com



**Tommy Isola**

Principal | AGT DRE #01974024  
310.899.2709  
tisola@LEEWESTLA.COM



**Adam Levine**

Associate | AGT DRE #02104830  
310.899.2703  
alevine@leewestla.com



A DIVISION OF  
**LEE & ASSOCIATES**