

8577 Higuera St

Culver City, CA 90232



New Flex/Creative Space for Lease in Culver City

8577 Higuera St

Culver City, CA 90232



BUILDING

± 856 SF

PRICE

\$3.50/SF, MG

PARKING

1 Total Spot

OCCUPANCY

Vacant

FEATURES

High Ceilings and Natural Light
One Grade Level Roll Up Door

8577 Higuera St
Culver City, CA 90232

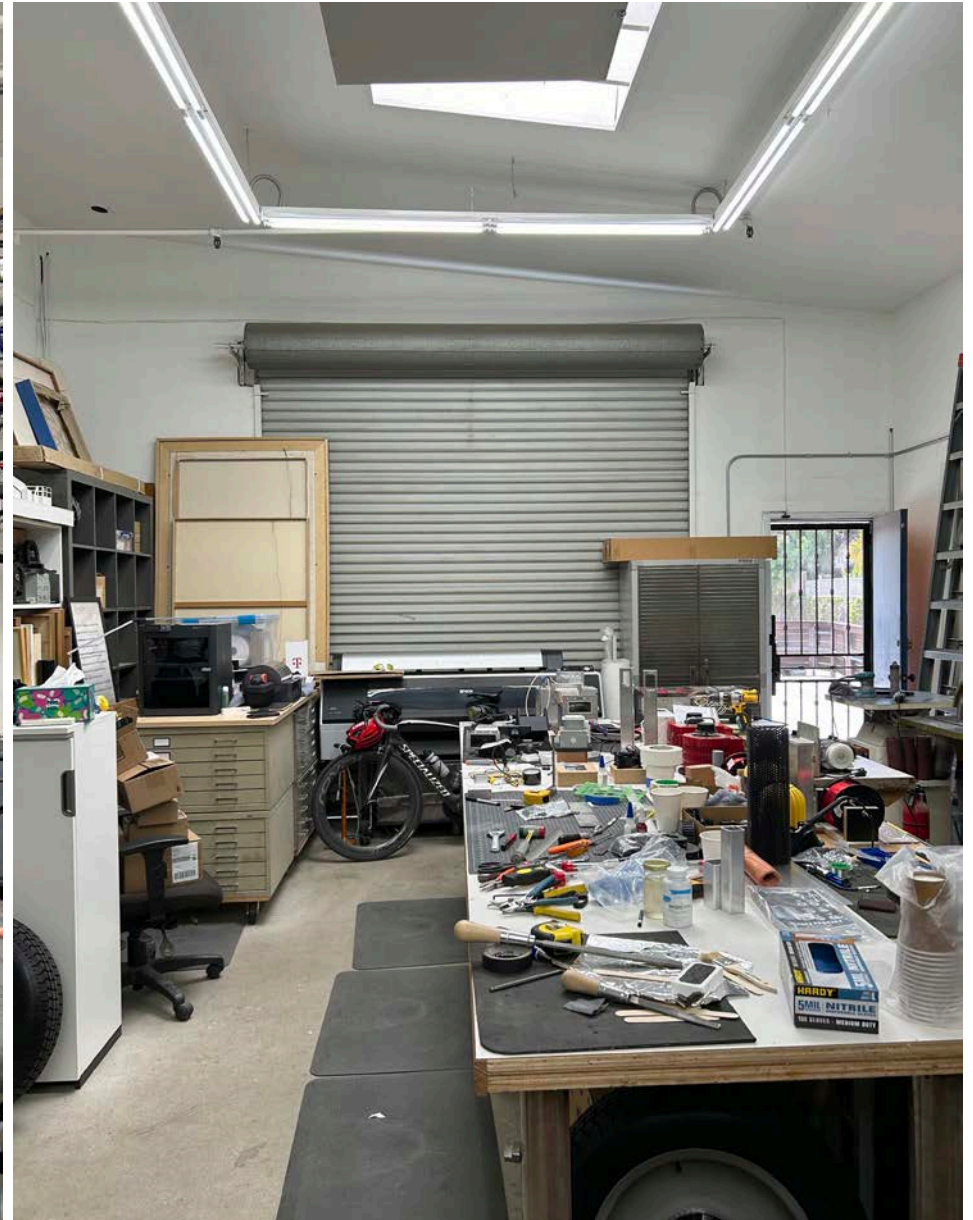
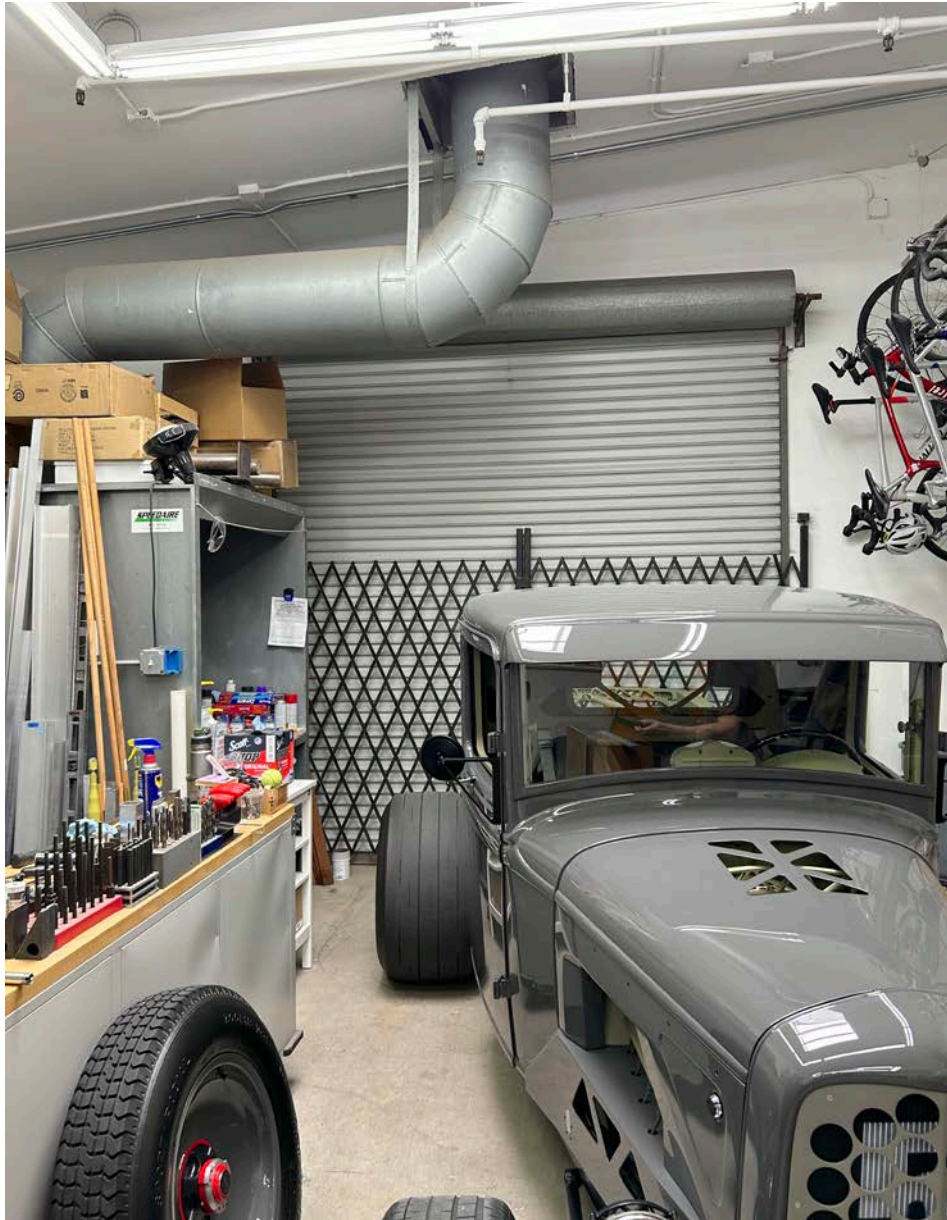

8577 Higuera St

Culver City, CA 90232

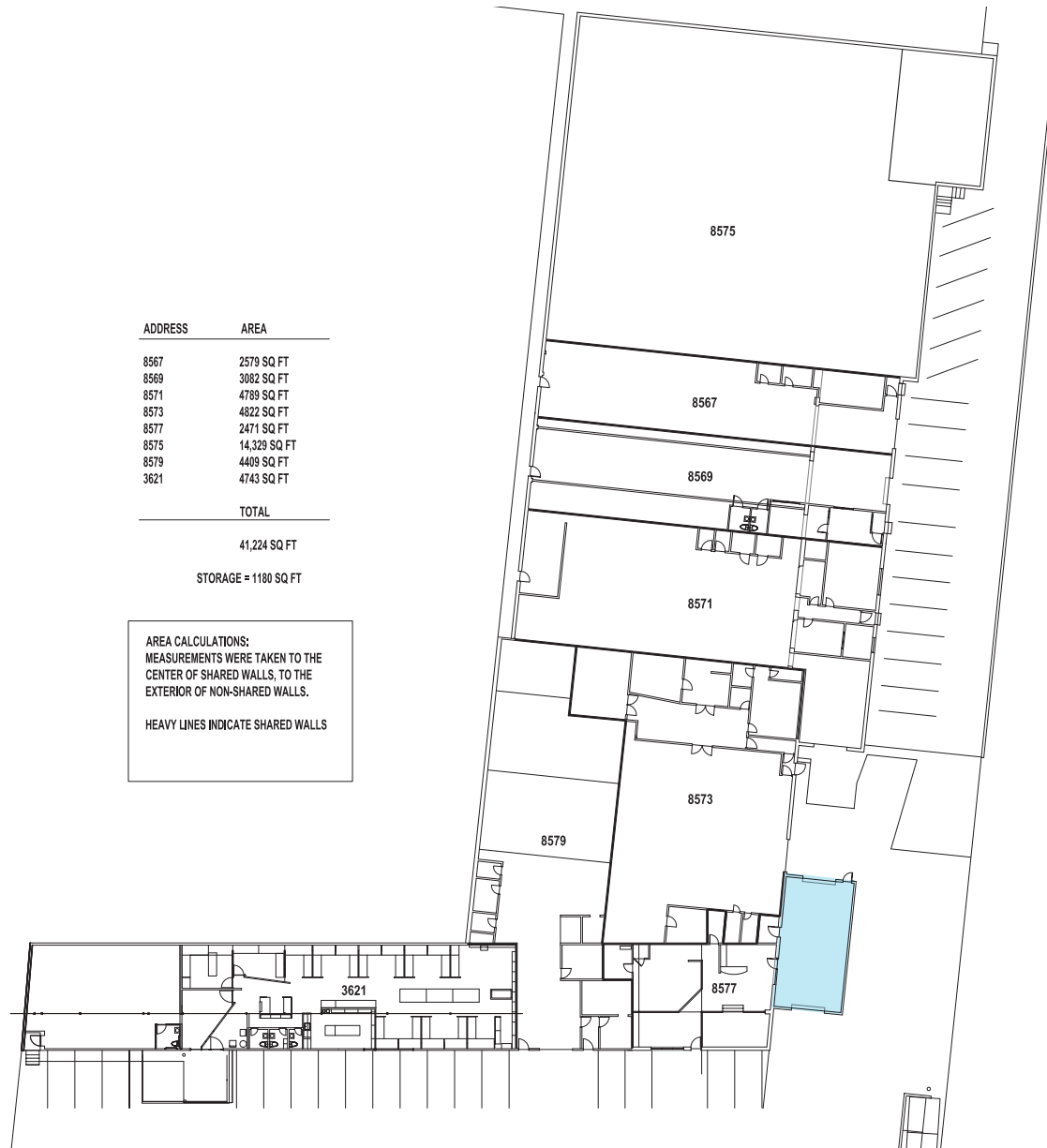

ADDRESS	AREA
8567	2579 SQ FT
8569	3082 SQ FT
8571	4789 SQ FT
8573	4822 SQ FT
8577	2471 SQ FT
8575	14,329 SQ FT
8579	4409 SQ FT
3621	4743 SQ FT
TOTAL	
	41,224 SQ FT
STORAGE = 1180 SQ FT	

AREA CALCULATIONS:
MEASUREMENTS WERE TAKEN TO THE
CENTER OF SHARED WALLS, TO THE
EXTERIOR OF NON-SHARED WALLS.

HEAVY LINES INDICATE SHARED WALLS

8577 Higuera St
Culver City, CA 90232



Ian Ameche

310.899.2748
iameche@leewestla.com
AGT DRE 01976053

Alex Rivera

310.899.2742
arivera@leewestla.com
AGT DRE 01328712

Douglas R. Marshall, SIOR

310.899.2745
dmarshall@leewestla.com
AGT DRE 02075191

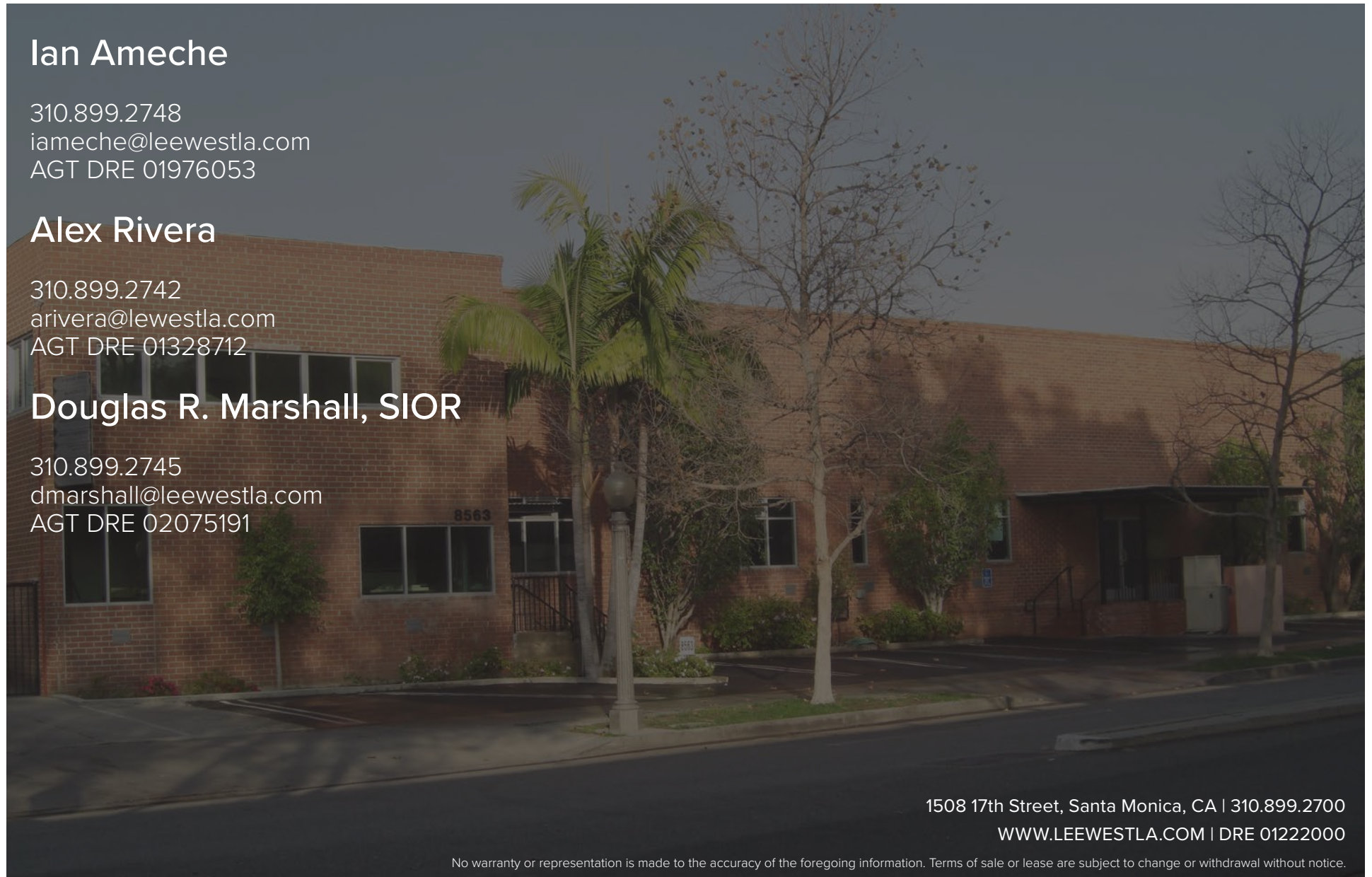

1508 17th Street, Santa Monica, CA | 310.899.2700

WWW.LEEWESTLA.COM | DRE 01222000

No warranty or representation is made to the accuracy of the foregoing information. Terms of sale or lease are subject to change or withdrawal without notice.