

# 8577 Higuera St

Culver City, CA 90232



New Flex/Creative Space for Lease in Culver City



**8577 Higuera St**  
Culver City, CA 90232



**BUILDING**

± 856 SF

**PRICE**

\$3.50/SF, MG

**PARKING**

1 Total Spot

**OCCUPANCY**

September 1, 2024

**FEATURES**

High Ceilings and Natural Light  
One Grade Level Roll Up Door



8577 Higuera St  
Culver City, CA 90232

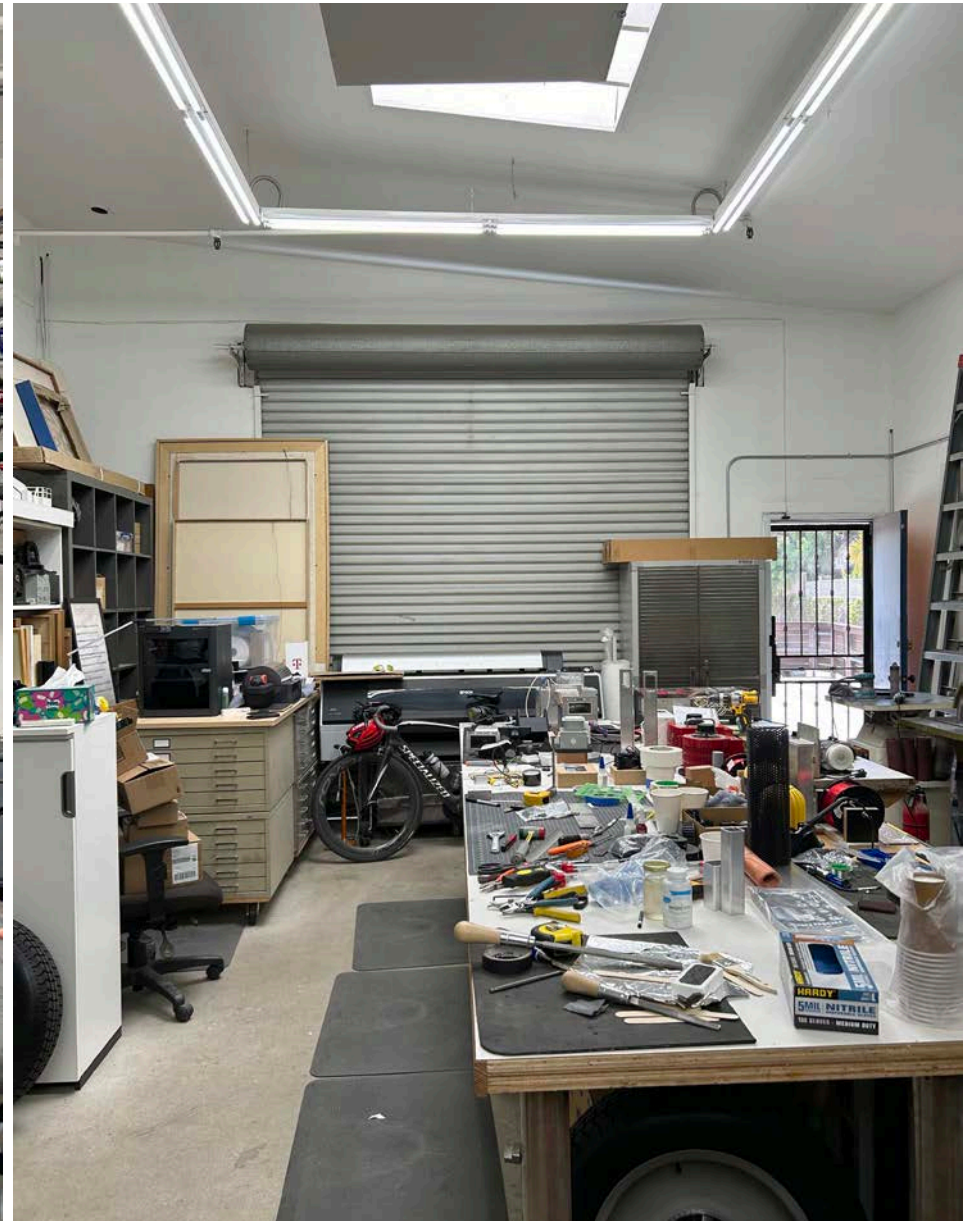
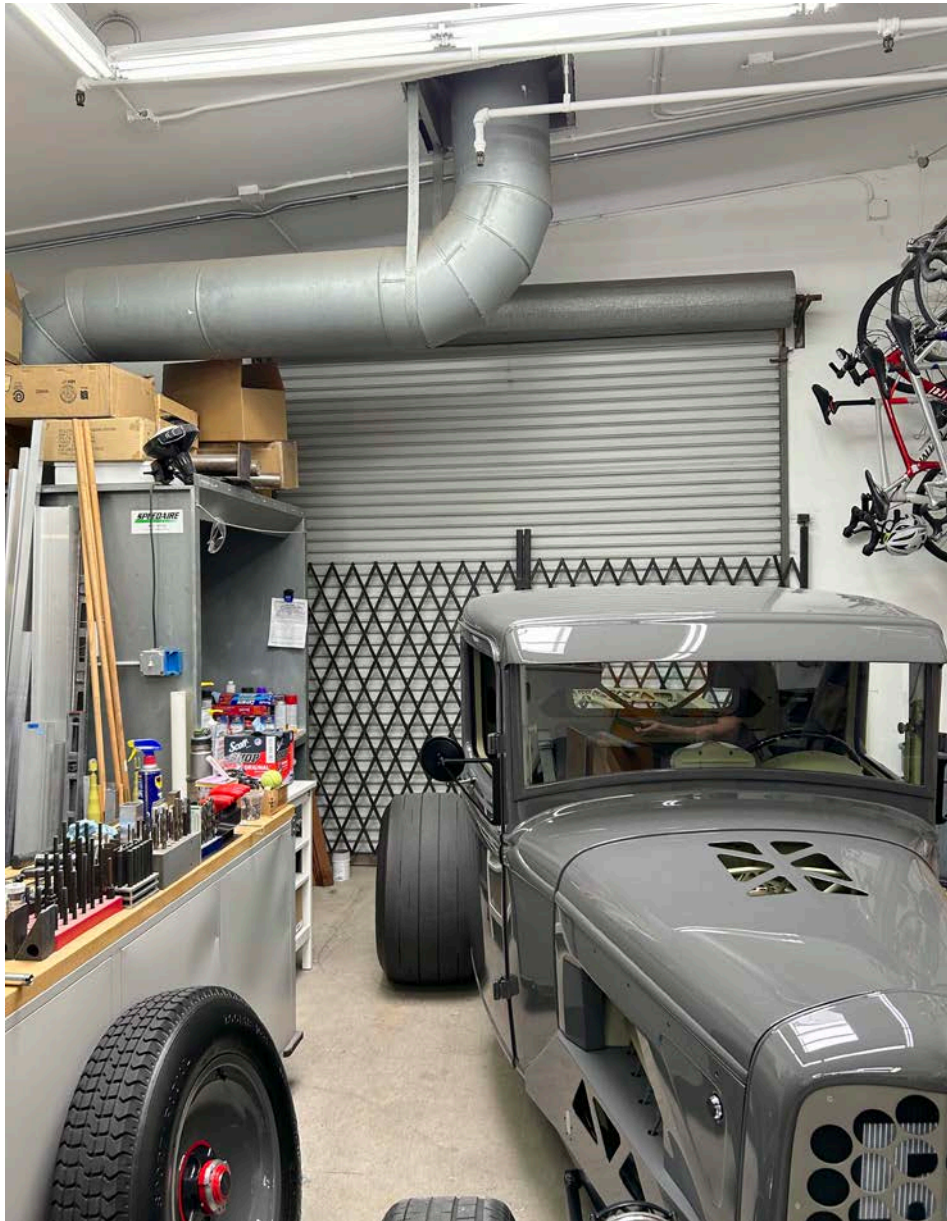

# 8577 Higuera St

Culver City, CA 90232

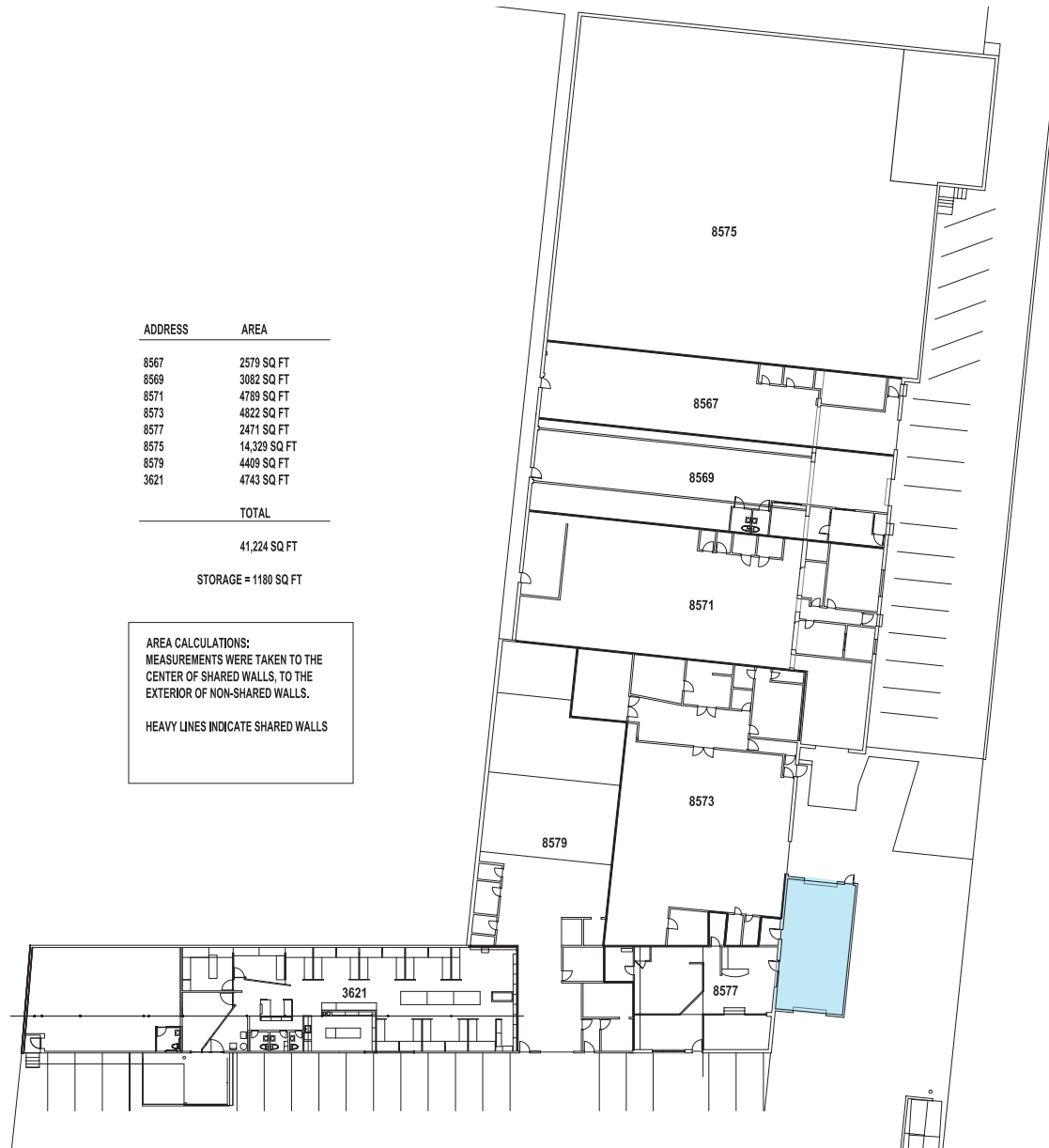

ADDRESS	AREA
8567	2579 SQ FT
8569	3082 SQ FT
8571	4789 SQ FT
8573	4822 SQ FT
8577	2471 SQ FT
8575	14,329 SQ FT
8579	4409 SQ FT
3621	4743 SQ FT
<b>TOTAL</b>	
	41,224 SQ FT
STORAGE = 1180 SQ FT	

AREA CALCULATIONS:  
MEASUREMENTS WERE TAKEN TO THE  
CENTER OF SHARED WALLS, TO THE  
EXTERIOR OF NON-SHARED WALLS.  
  
HEAVY LINES INDICATE SHARED WALLS



**8577 Higuera St**  
Culver City, CA 90232



## Ian Ameche

310.899.2748  
iameche@leewestla.com  
AGT DRE 01976053

## Douglas R. Marshall, SIOR

310.899.2745  
dmarshall@leewestla.com  
AGT DRE 02075191

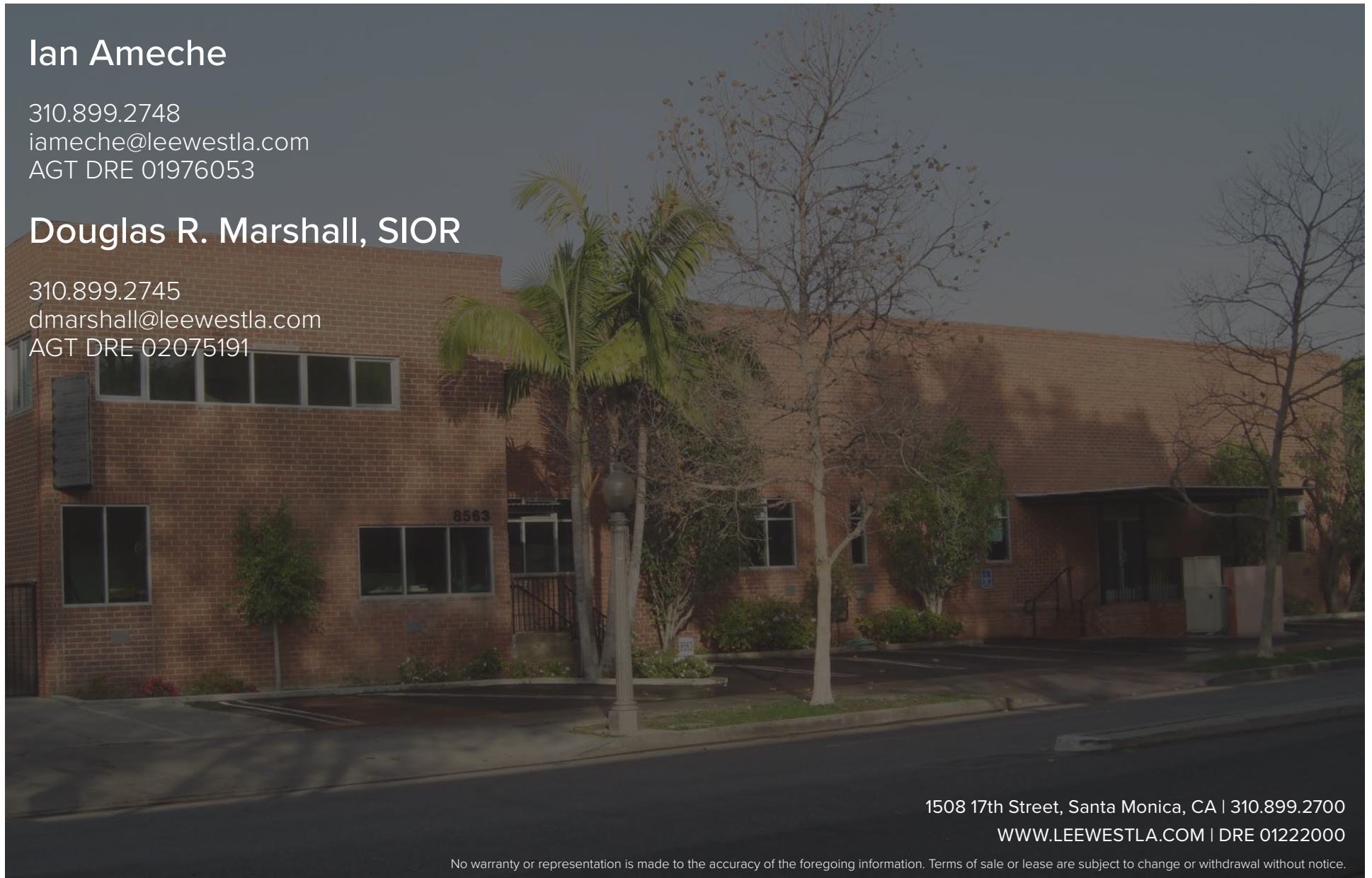

1508 17th Street, Santa Monica, CA | 310.899.2700

WWW.LEEWESTLA.COM | DRE 01222000

No warranty or representation is made to the accuracy of the foregoing information. Terms of sale or lease are subject to change or withdrawal without notice.